



November 5, 2019

To Whom It May Concern:

This is to acknowledge the receipt of a donation of approximately 4,200 sq ft of roofing metal to be used by the inmates in various work projects. The material has a value of \$6,328 as per the attached estimate. The donation was received from William B. Allan (Bill Allan) of Dike, Texas.

Lewis Tatum

Signature

Sheriff of Hopkins County

Title

Chas Newton - County Judge

Approved

WILLIAM\_ALLAN

Source - Eagle View

Source - Eagle View

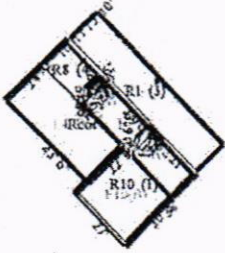

Roof

4214.56 Surface Area  
340.58 Total Perimeter Length

42.15 Number of Squares  
90.00 Total Ridge Length

DESCRIPTION	QUANTITY	UNIT PRICE	TAX	RCV	DEPREC.	ACV
1. R&R Metal roofing	4,214.56 SF	5.31	378.36	22,757.68	<3,580.69>	19,176.99
2. Remove Additional charge for steep roof - 10/12 - 12/12 slope	23.15 SQ	17.07	0.00	395.17	<0.00>	395.17
3. Additional charge for steep roof - 10/12 - 12/12 slope	23.15 SQ	53.89	0.00	1,247.55	<0.00>	1,247.55

$$\$19,176.99 \times 33\% = \$6,328.41$$